



* Rendering

83 Maiden Lane

Availabilities from 14,000-56,000 SF

DENHAM
WOLF

www.denhamwolf.com

83 Maiden Lane | Floors 3-6 For Lease



SPACE HIGHLIGHTS

- Newly Built Installation
- Polished Concrete Floors and LED Lighting
- Available Immediately
- Ideally Configured for Hybrid Workspace
- Close to Subways Lines and Ferries
- Prime FiDi Location
- Corner Location Facing a Plaza



* Rendering

The information contained herein has either been given to us by the owner of the property or obtained from sources that we deem reliable. We have no reason to doubt its accuracy but we do not guarantee it. All zoning, existing and buildable square footages, and uses must be independently verified. The prospective buyer should carefully verify all information contained herein. © 2023 Denham Wolf

DENHAM
WOLF

83 Maiden Lane | Floors 3-6 For Lease



SPACE DETAILS

LOCATION

On the NW corner of Gold Street & Maiden Lane

PREMISES

Entire 3 14,000 RSF

Entire 4 14,000 RSF

Entire 5 14,000 RSF

Entire 6 14,000 RSF

Total 56,000 RSF

CEILING HEIGHTS

10' 9"

RATE

Upon Request

POSSESSION

Immediate

TERM

Flexible

ADDITIONAL DETAILS

- Open Floor Plan with Meeting Rooms & Conference Rooms Pre-Built
- New Modern Kitchen /Pantry
- High End Bathrooms
- Floors Can Be Leased Separately

[Virtual Tour](#)

The information contained herein has either been given to us by the owner of the property or obtained from sources that we deem reliable. We have no reason to doubt its accuracy but we do not guarantee it. All zoning, existing and buildable square footages, and uses must be independently verified. The prospective buyer should carefully verify all information contained herein. © 2023 Denham Wolf

DENHAM
WOLF

83 Maiden Lane | Floors 3-6 For Lease



The information contained herein has either been given to us by the owner of the property or obtained from sources that we deem reliable. We have no reason to doubt its accuracy but we do not guarantee it. All zoning, existing and buildable square footages, and uses must be independently verified. The prospective buyer should carefully verify all information contained herein. © 2023 Denham Wolf

DENHAM
WOLF

83 Maiden Lane | Floors 3-6 For Lease

TYPICAL FLOOR PLAN | 14,000 RSF

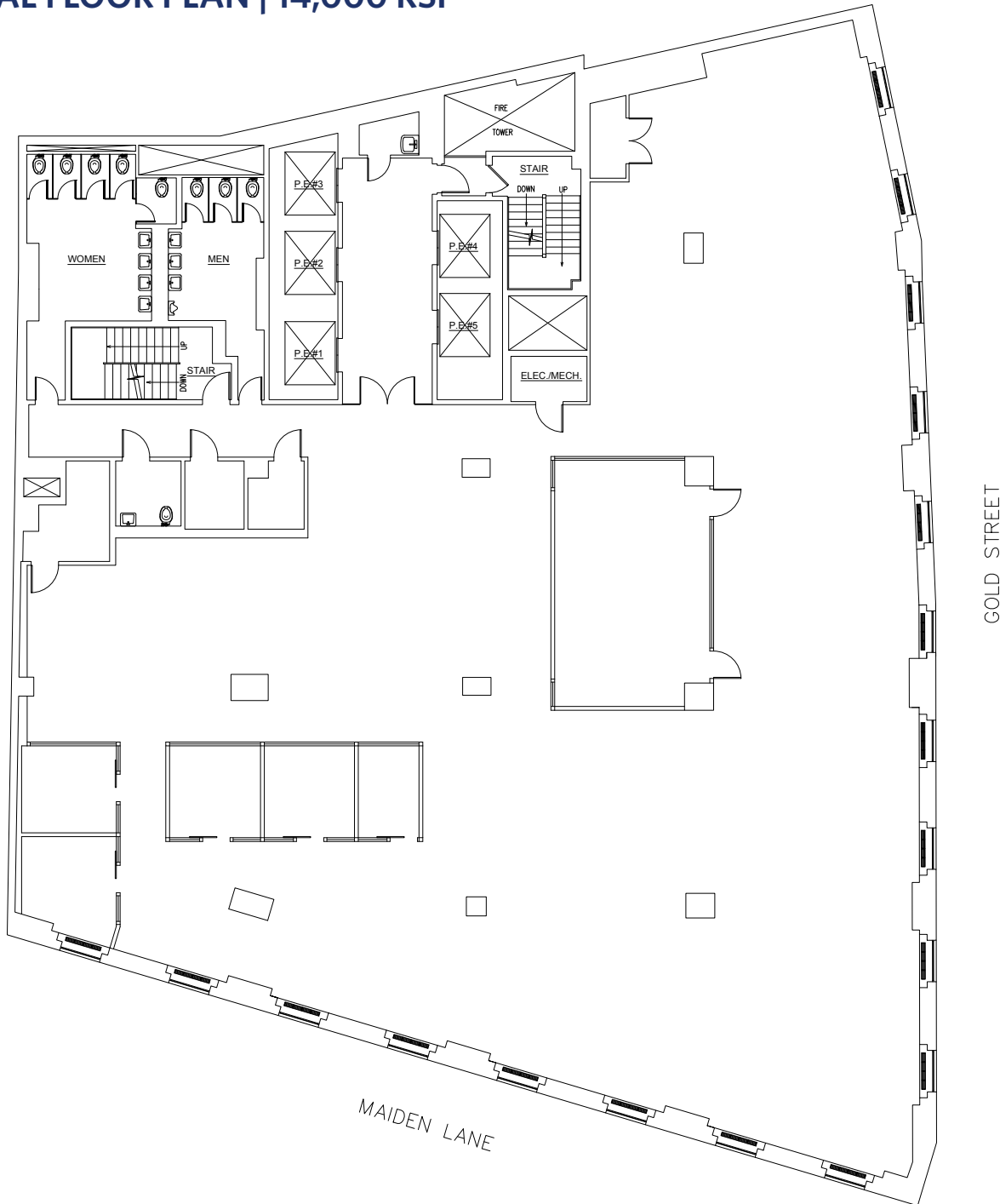

The information contained herein has either been given to us by the owner of the property or obtained from sources that we deem reliable. We have no reason to doubt its accuracy but we do not guarantee it. All zoning, existing and buildable square footages, and uses must be independently verified. The prospective buyer should carefully verify all information contained herein. © 2023 Denham Wolf

83 Maiden Lane | Floors 3-6 For Lease

COLLABORATIVE OFFICE CONFIGURATION | 14,000 RSF | 56 DESKS

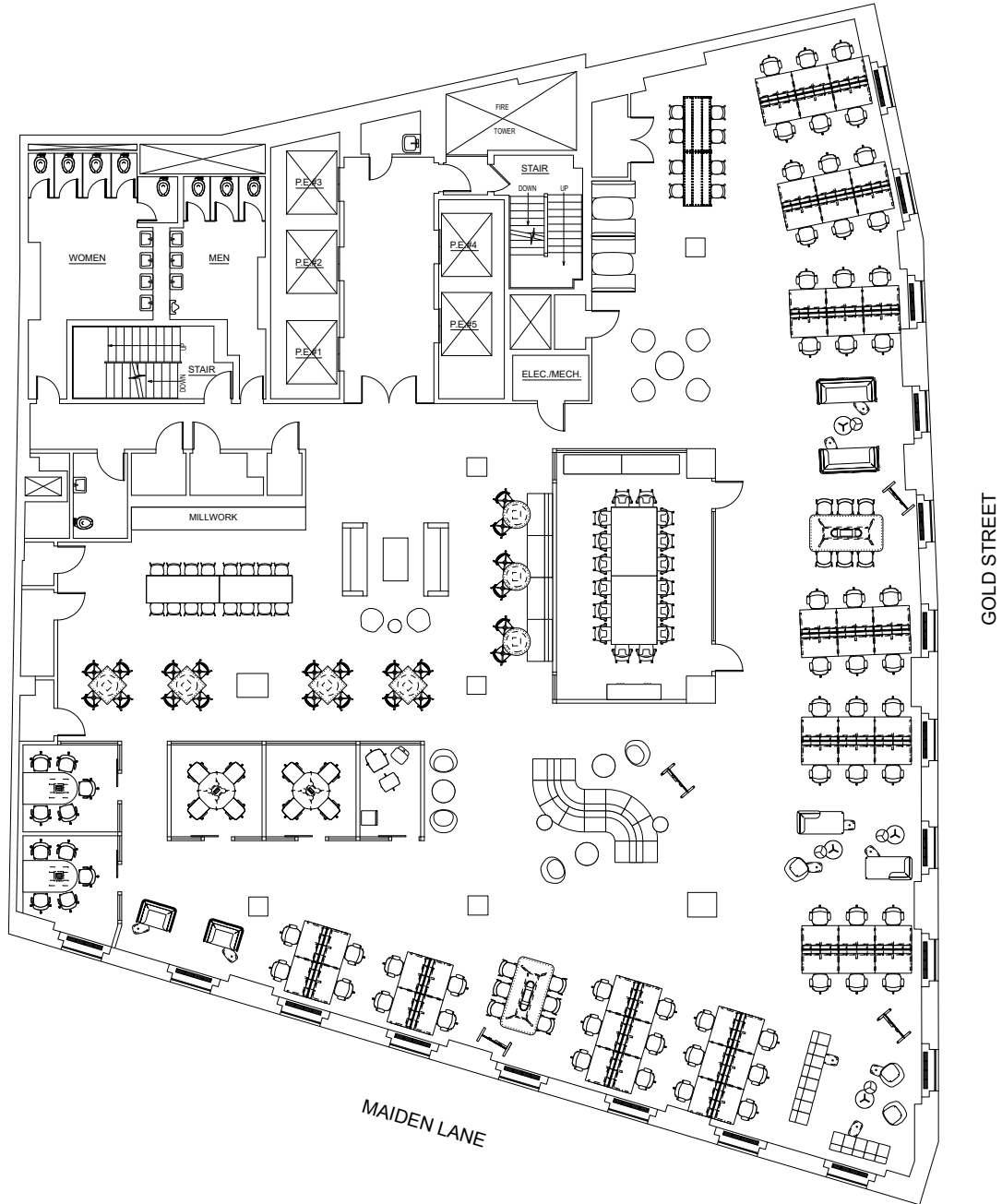

The information contained herein has either been given to us by the owner of the property or obtained from sources that we deem reliable. We have no reason to doubt its accuracy but we do not guarantee it. All zoning, existing and buildable square footages, and uses must be independently verified. The prospective buyer should carefully verify all information contained herein. © 2023 Denham Wolf

DENHAM
WOLF

83 Maiden Lane | Floors 3-6 For Lease

HIGH DENSITY CONFIGURATION | 14,000 RSF | 116 DESKS TEST FIT

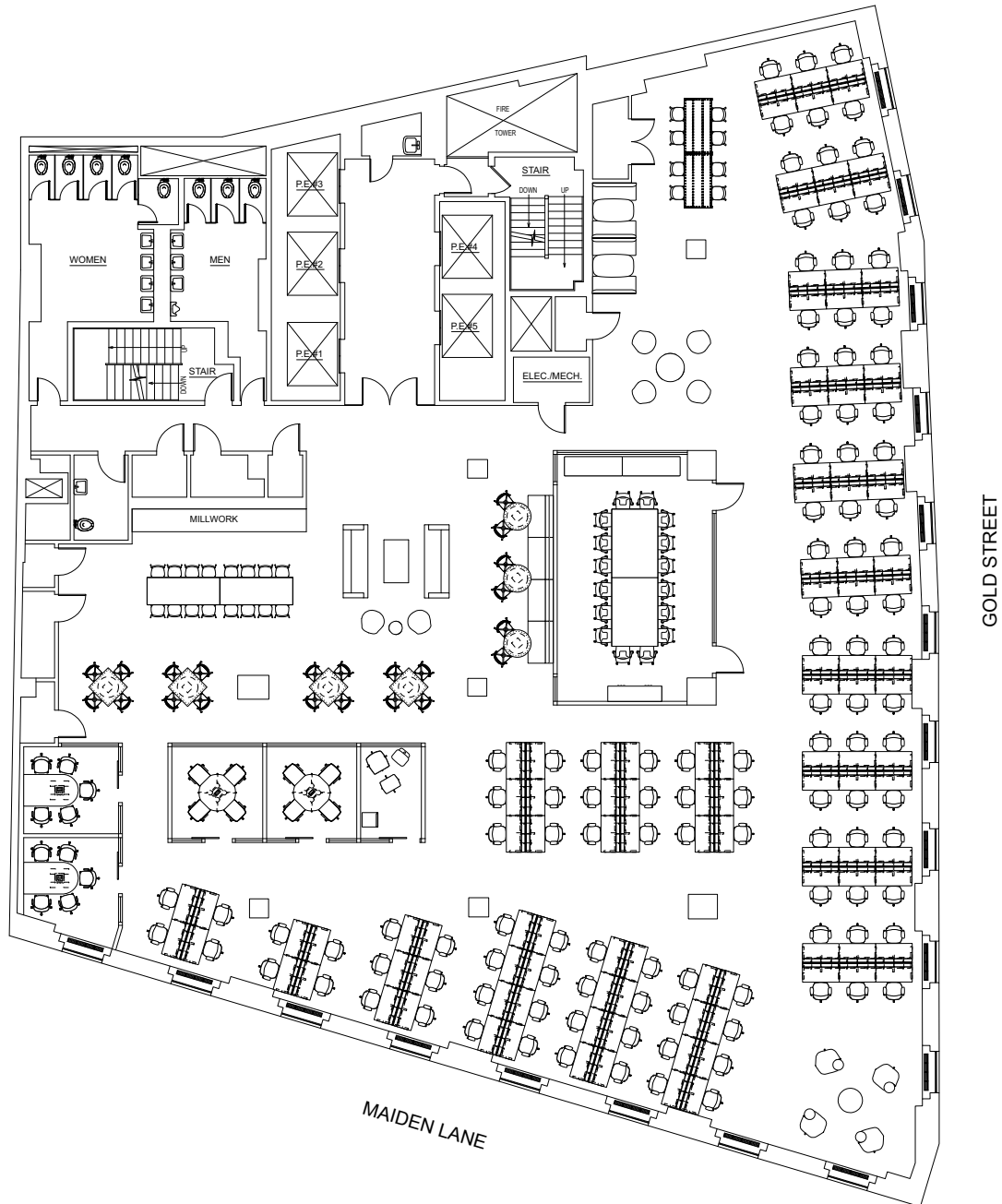

The information contained herein has either been given to us by the owner of the property or obtained from sources that we deem reliable. We have no reason to doubt its accuracy but we do not guarantee it. All zoning, existing and buildable square footages, and uses must be independently verified. The prospective buyer should carefully verify all information contained herein. © 2023 Denham Wolf

DENHAM
WOLF

83 Maiden Lane | Floors 3-6 For Lease

VIBRANT NEIGHBORHOOD

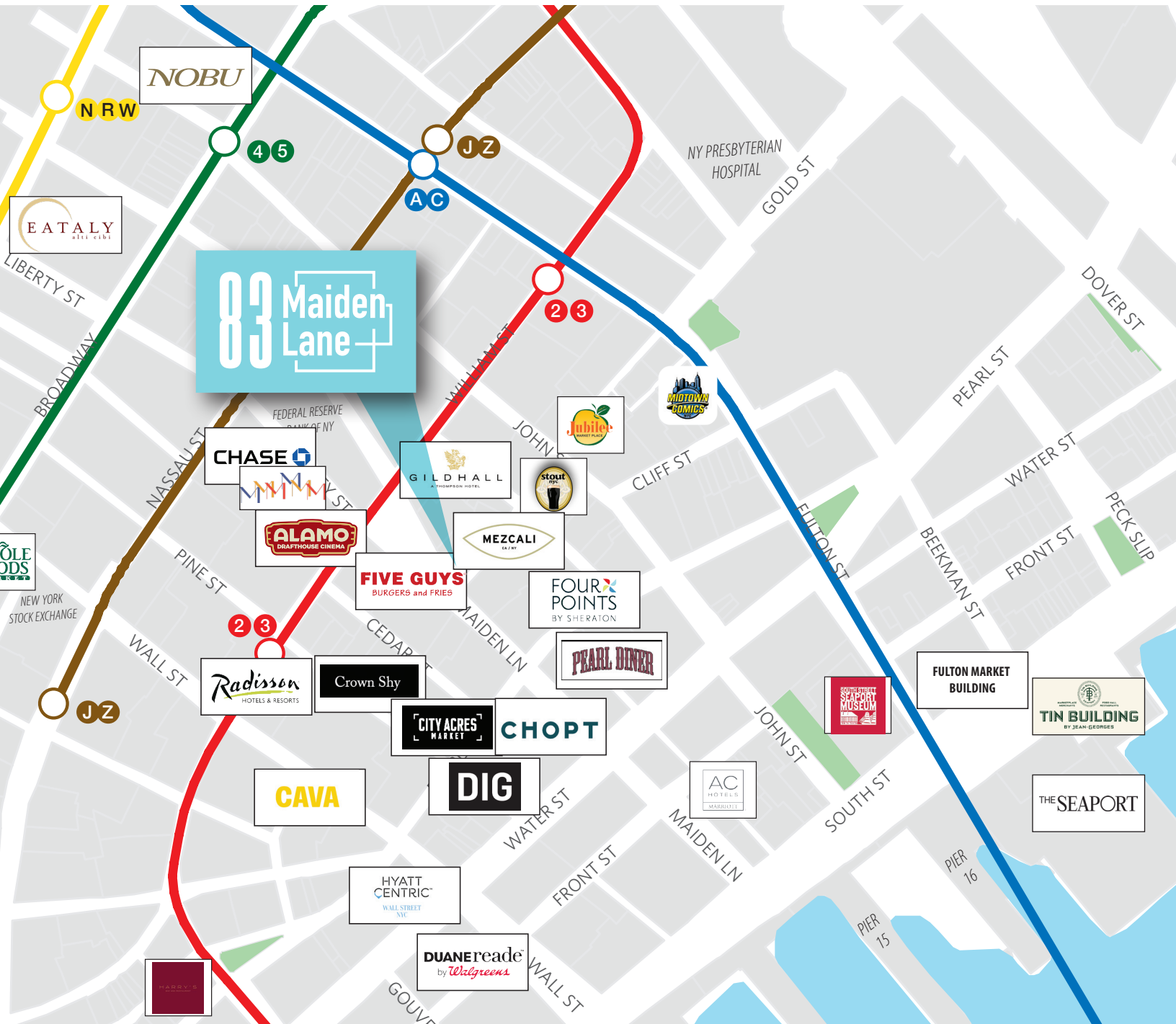

The information contained herein has either been given to us by the owner of the property or obtained from sources that we deem reliable. We have no reason to doubt its accuracy but we do not guarantee it. All zoning, existing and buildable square footages, and uses must be independently verified. The prospective buyer should carefully verify all information contained herein. © 2023 Denham Wolf

83 Maiden Lane | Floors 3-6 For Lease



COMMUTE TIMES TO MAJOR TRANSIT HUBS THROUGHOUT THE CITY:

16 MINS | PENN STATION

20 MINS | PORT AUTHORITY BUS TERMINAL

18 MINS | GRAND CENTRAL TERMINAL

18 MINS | ATLANTIC / BARCLAYS CENTER

8 MINS | NYC FERRY TERMINAL

12 MINS | HOBOKEN PATH STATION

NEARBY ACCESS TO



The information contained herein has either been given to us by the owner of the property or obtained from sources that we deem reliable. We have no reason to doubt its accuracy but we do not guarantee it. All zoning, existing and buildable square footages, and uses must be independently verified. The prospective buyer should carefully verify all information contained herein. © 2023 Denham Wolf

DENHAM
WOLF

83 Maiden Lane

83 Maiden Lane

Agency
Humanity
Reimagined
Group

AHRC
NYC

BOOK YOUR TOUR TODAY

Kate Hrobsky

khrobsky@denhamwolf.com

646.814.8856

Christopher Turner

cturner@denhamwolf.com

212.629.7012

DENHAM
WOLF

www.denhamwolf.com